

**GIRDER PLACEMENT - STEP 1**

1. DELIVER GIRDER ANYWHERE BETWEEN THE RLCB PROPS ON JIBBER AND PRIME MOVER
2. FULLY LIFT GIRDER INTO FRONT GANTRY
3. INSTALL GIRDER PROPS

**SIDE ELEVATION**

COPYRIGHT - INFORMATION SUPPLIED ON THIS DRAWING BELONGS TO J.K. WATSON ENGINEERING AND CANNOT BE USED COPIED OR REPRODUCED IN ANY FORM WITHOUT WRITTEN PERMISSION FROM J.K. WATSON ENGINEERING



236 Cavendish Rd,  
Coorparoo, 4151  
Ph (07) 3511 7866  
Fx (07) 3511 7866

Ingenuity & Innovation

CLIENT:  
ARENCO

PROJECT:  
HUNTER RIVER BRIDGE

DRAWN: J.WATSON  
DESIGNED: J.WATSON  
CHECKED: J.WATSON  
APPROVED: [Signature]

DATE: SEP 07  
DATE: SEP 07  
DATE: SEP 07  
DATE: [Blank]

INITIAL: J.K.W.  
INITIAL: J.K.W.  
INITIAL: J.K.W.  
INITIAL: [Blank]

SIGNATURE: [Signature]  
SIGNATURE: [Signature]  
SIGNATURE: [Signature]  
SIGNATURE: [Signature]

SCALE: 1:100 (A1)

REV.	DESCRIPTION	DATE
0	ISSUED FOR CONSTRUCTION	10-12-07
C	ISSUED FOR FINAL DESIGN CHECK & MATERIAL SOURCING	1-11-07
B	RE POSITION GANTRY RAIL BEAM	22-10-07
A	ISSUED FOR COMMENT	17-9-07

TITLE:  
GANTRY ERECTION SYSTEM  
GIRDER PLACEMENT  
SHEET 1 OF 5

DWG NO: JKW-TS-101 REV: 0

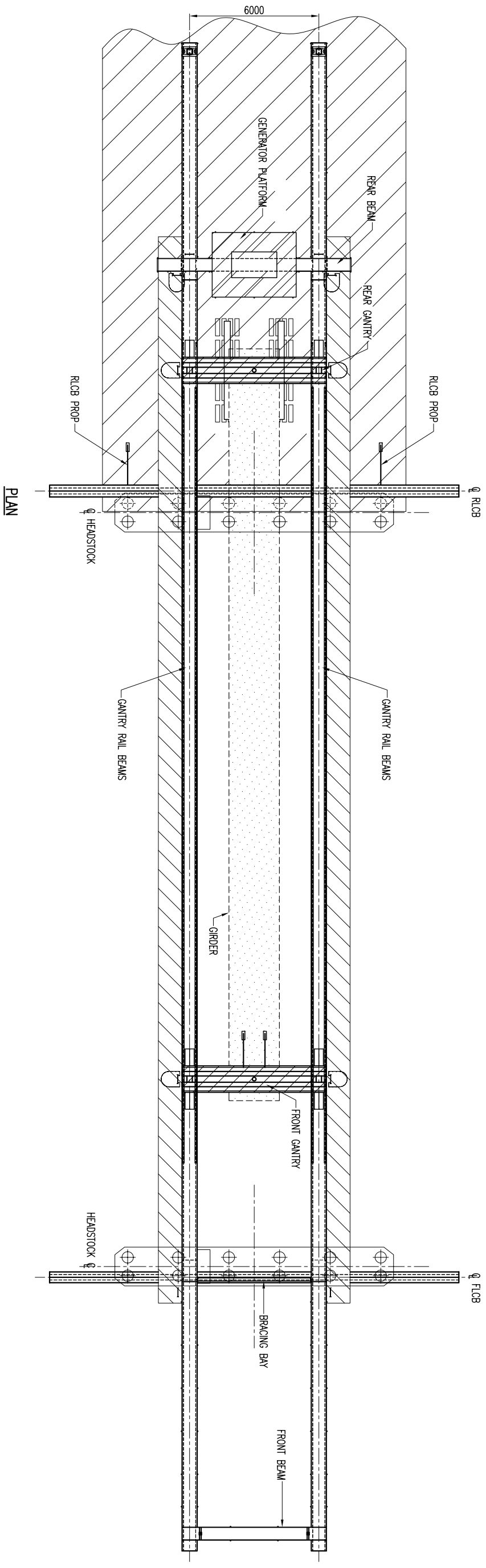

PLAN

70000 O/A

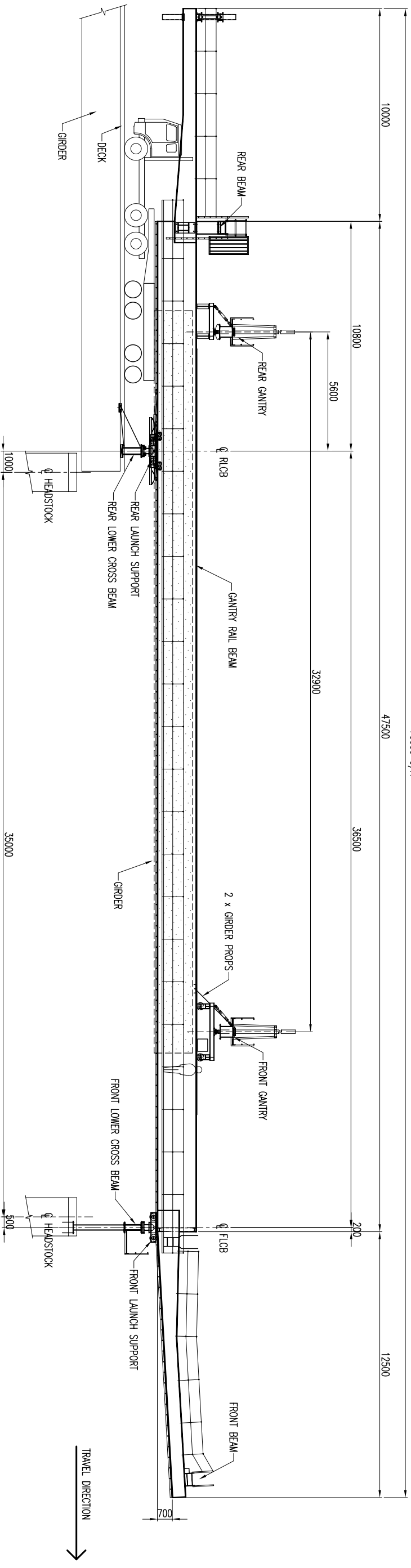

GIRDER PLACEMENT - STEP 2

1. PUSH GIRDER INTO SYSTEM BY PRIME MOVER UNTIL REAR OF GIRDER AT REAR GANTRY
2. LIFT REAR OF GIRDER INTO REAR GANTRY

SIDE ELEVATION

COPYRIGHT - INFORMATION SUPPLIED ON THIS DRAWING BELONGS TO J.K. WATSON ENGINEERING AND CANNOT BE USED, COPIED OR REPRODUCED IN ANY FORM WITHOUT WRITTEN PERMISSION FROM J.K. WATSON ENGINEERING



Ingenuity & Innovation

236 Cavendish Rd,  
Coorparoo, 4151  
Ph (07) 3511 7866  
Fx (07) 3511 7866

CLIENT:  
ARENCO

PROJECT:  
HUNTER RIVER BRIDGE

DRAWN: J.K. WATSON  
DATE: SEP 07  
INITIAL: J.K.W.  
SIGNATURE: [Signature]

DESIGNED: J.K. WATSON  
DATE: SEP 07  
INITIAL: J.K.W.  
SIGNATURE: [Signature]

CHECKED: J.K. WATSON  
DATE: [ ]  
INITIAL: J.K.W.  
SIGNATURE: [Signature]

APPROVED: [Signature]

REV.	DESCRIPTION	DATE
0	ISSUED FOR CONSTRUCTION	10-12-07
C	ISSUED FOR FINAL DESIGN CHECK & MATERIAL SOURCING	1-11-07
B	RE POSITION GANTRY RAIL BEAMS	22-10-07
A	ISSUED FOR COMMENT	17-9-07

SCALE: 1:100 (A1)

TITLE:  
GANTRY ERECTION SYSTEM  
GIRDER PLACEMENT  
SHEET 2 OF 5

DWG NO: JKW-TS-102 REV: 0

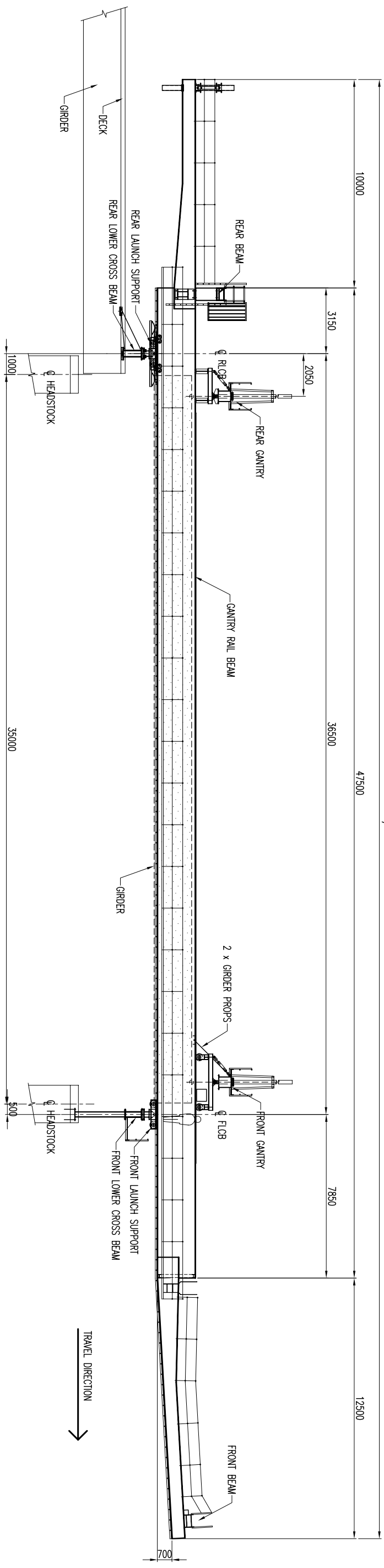
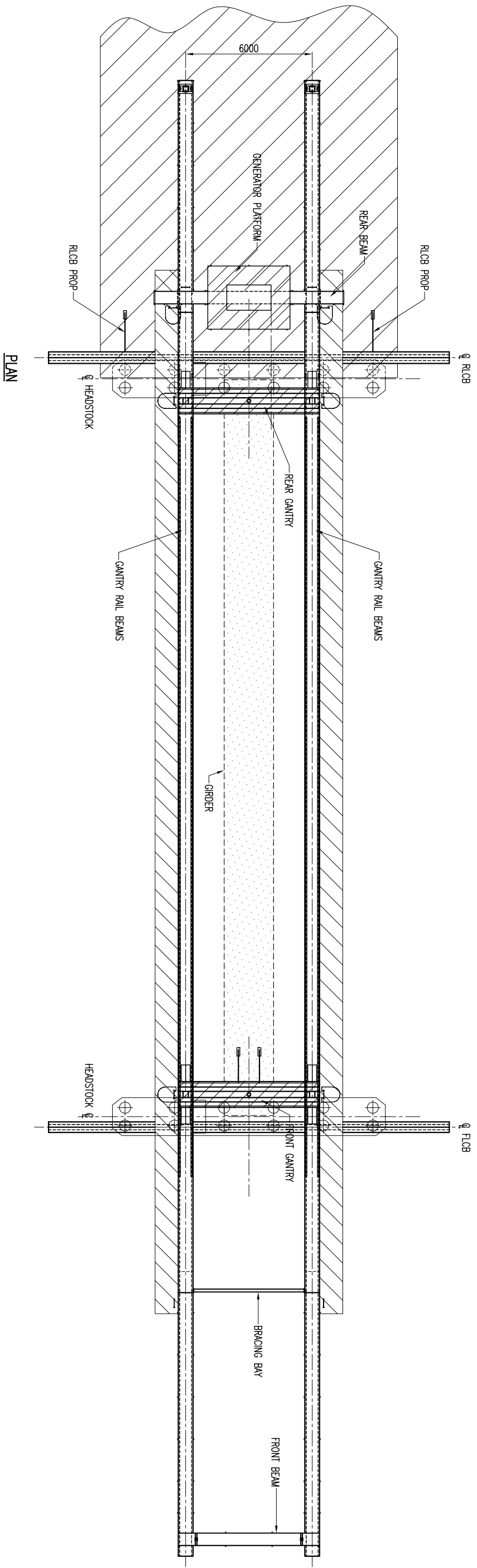

SIDE ELEVATION

GIRDER PLACEMENT - STEP 3

1. DRIVE FORWARD GANTRY RAIL BEAMS INTO LONG POSITION

REV.	DESCRIPTION	DATE
0	ISSUED FOR CONSTRUCTION	10-12-07
C	ISSUED FOR FINAL DESIGN CHECK & MATERIAL SOURCING	1-11-07
B	RE POSITION GANTRY RAIL BEAM	22-10-07
A	ISSUED FOR COMMENT	17-9-07

SCALE: 1:100 (A1)

TITLE: GANTRY ERECTION SYSTEM  
GIRDER PLACEMENT  
SHEET 3 OF 5

COPYRIGHT - INFORMATION SUPPLIED ON THIS DRAWING BELONGS TO J.K. WATSON ENGINEERING AND CANNOT BE USED COPIED OR REPRODUCED IN ANY FORM WITHOUT WRITTEN PERMISSION FROM J.K. WATSON ENGINEERING



236 Cavendish Rd,  
Coorparoo, 4151  
Ph (07) 3511 7866  
Fx (07) 3511 7866

CLIENT: ARENCO  
PROJECT: HUNTER RIVER BRIDGE

DRAWN: J. WATSON  
DESIGNED: J. WATSON  
CHECKED: J. WATSON  
APPROVED: J. WATSON

DWG NO: JKW-TS-103  
REV: 0

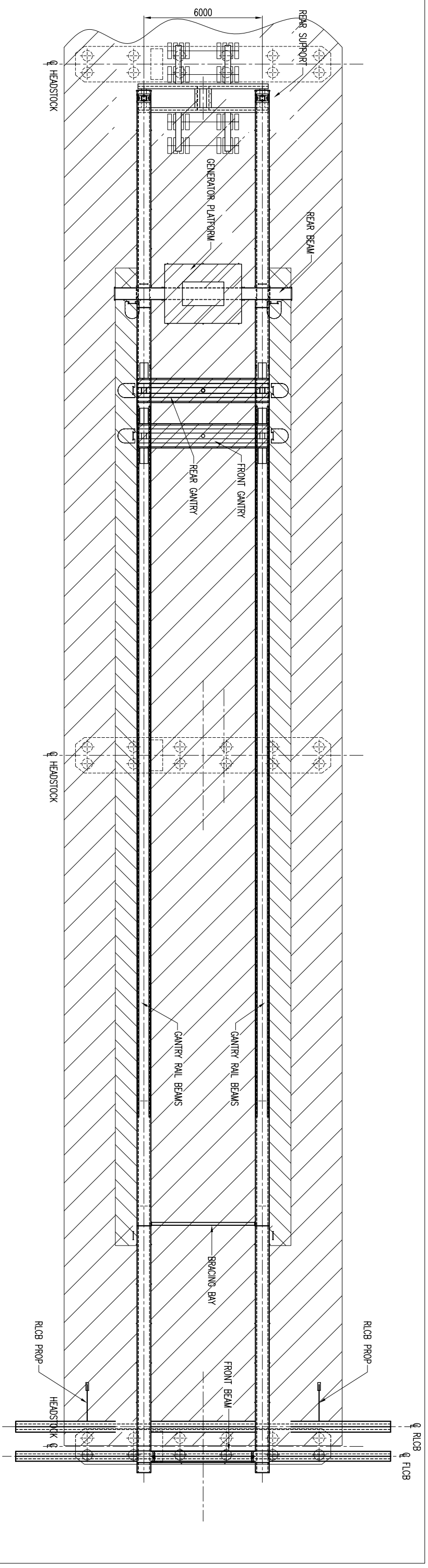

PLAN - ERECTION SYSTEM

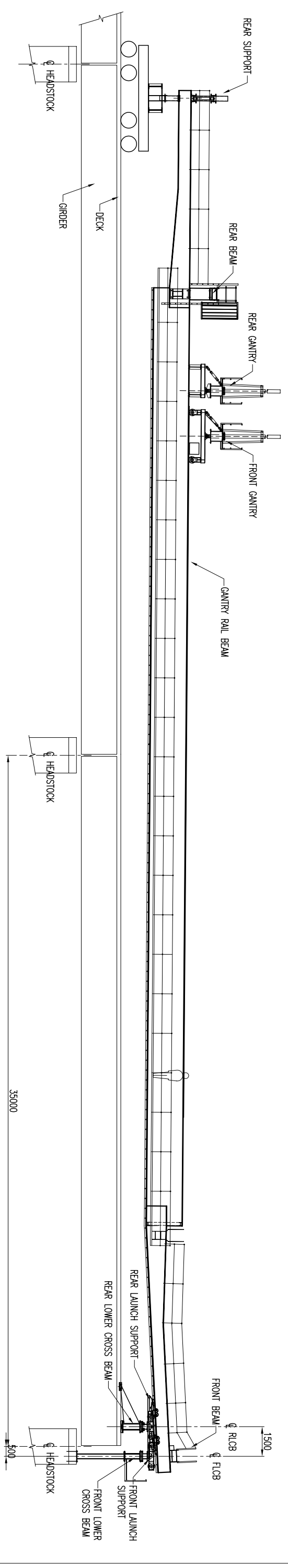

SIDE ELEVATION

LAUNCH SEQUENCE - STEP 3

1. JACK DOWN GANTRY RAILS AT REAR SUPPORT
2. LAUNCH BACKWARDS ON REAR LOWER CROSS BEAM & REAR SUPPORT UNTIL FRONT LOWER CROSS BEAM IS UNDER THE FRONT BEAM

COPYRIGHT - INFORMATION SUPPLIED ON THIS DRAWING BELONGS TO J.K. WATSON ENGINEERING AND CANNOT BE USED COPIED OR REPRODUCED IN ANY FORM WITHOUT WRITTEN PERMISSION FROM J.K. WATSON ENGINEERING



236 Cavendish Rd,  
Coorparoo, 4151  
Ph (07) 3511 7866  
Fx (07) 3511 7866  
Ingenuity & Innovation

CLIENT: ARENCO  
PROJECT: HUNTER RIVER BRIDGE

DRAWN: J. WATSON	DATE: SEP 07	INITIAL: J.K.W.	SIGNATURE: [Signature]
DESIGNED: J. WATSON	DATE: SEP 07	INITIAL: J.K.W.	SIGNATURE: [Signature]
CHECKED: [Signature]	DATE: [Date]	INITIAL: [Initials]	SIGNATURE: [Signature]
APPROVED: [Signature]	DATE: [Date]	INITIAL: [Initials]	SIGNATURE: [Signature]

REV.	DESCRIPTION	DATE
0	ISSUED FOR CONSTRUCTION	10-12-07
B	ISSUED FOR FINAL DESIGN CHECK & MATERIAL SOURCING	1-11-07
A	ISSUED FOR COMMENT	17-9-07

SCALE: 1:100 (A1)  
TITLE: GANTRY ERECTION SYSTEM  
LAUNCH SEQUENCE  
SHEET 3 OF 5  
Dwg No: JKW-TS-123  
REV: 0

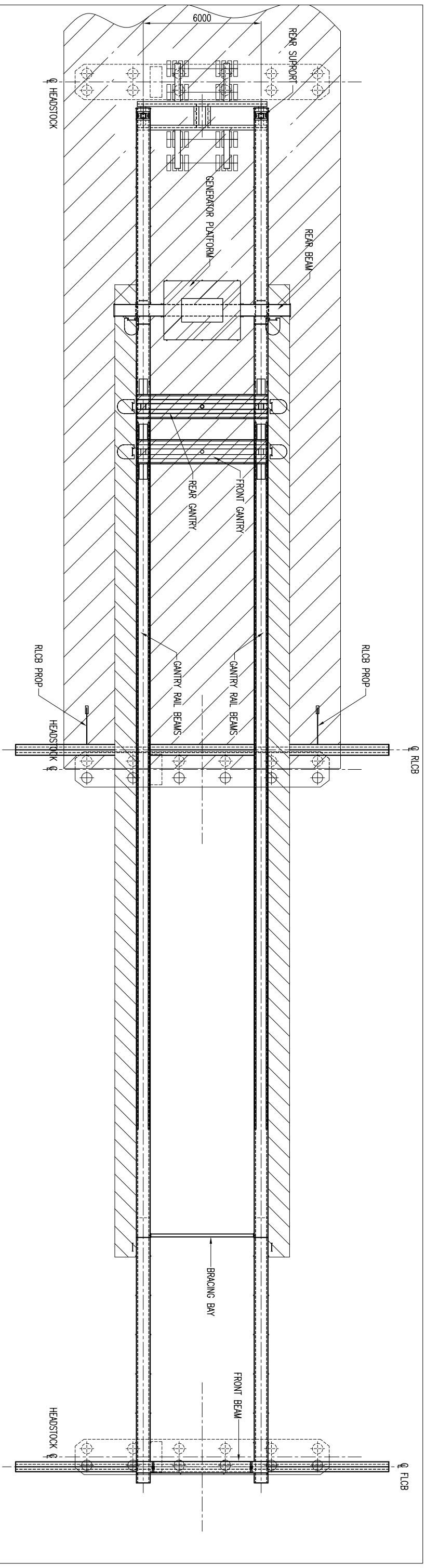

PLAN - ERECTION SYSTEM

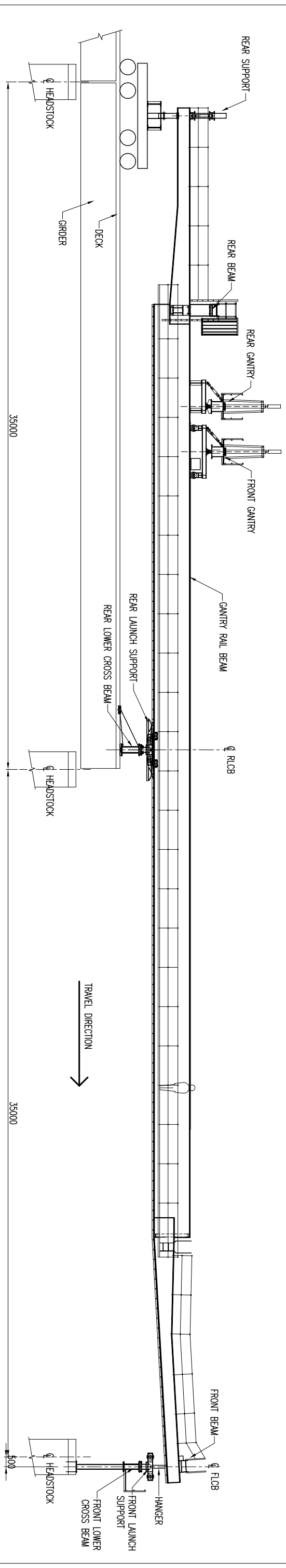

SIDE ELEVATION

LAUNCH SEQUENCE - STEP 4

1. LAUNCH FORWARD ON REAR LOWER CROSS BEAM & REAR SUPPORT UNTIL FRONT LOWER CROSS BEAM IS OVER HEADSTOCK
2. RAISE THE REAR SUPPORT TO LAND THE FRONT LOWER CROSS BEAM ON THE HEADSTOCK AND SECURE

COPYRIGHT - INFORMATION SUPPLIED ON THIS DRAWING BELONGS TO J.K. WATSON ENGINEERING AND CANNOT BE USED COPIED OR REPRODUCED IN ANY FORM WITHOUT WRITTEN PERMISSION FROM J.K. WATSON ENGINEERING



Ingenuity & Innovation

236 Cavendish Rd,  
Coorparoo, 4151  
Ph (07) 3511 7866  
Fx (07) 3511 7866

CLIENT:  
ARENCO

PROJECT:  
HUNTER RIVER BRIDGE

REV.	DESCRIPTION	DATE	SCALE
0	ISSUED FOR CONSTRUCTION	10-12-07	
B	ISSUED FOR FINAL DESIGN CHECK & MATERIAL SOURCING	1-11-07	
A	ISSUED FOR COMMENT	17-9-07	

DATE	INITIAL	SIGNATURE	REFERENCE
DESIGNED	J.K.W.	J.K. WATSON	DESIGN
CHECKED	J.K.W.	J.K. WATSON	CHECK
APPROVED	J.K.W.	J.K. WATSON	APPROVE

DWG NO: JKW-TS-124  
REV: 0